

SPA-0P8-2P5-300 Solid State Power Amplifier

(0.8GHz - 2.5GHz, 300W)

Key Features

- Multi-octave broadband performance
- High output power
- Wide dynamic range
- High-efficiency GaN technology
- Low power consumption
- Low spurious signal
- Forward/reverse power monitoring
- Extremely load-resistant
- Over voltage, over temperature, over current protection



Overview

Saluki SPA-0P8-2P5-300 is a solid-state RF power amplifier with an output frequency of 0.8GHz to 2.5GHz and an output power of 300W. Its design is based on the most advanced GaN technology in the industry, and its power output is efficient and reliable. It is mainly used for testing and measuring instruments, Communication or interference, aviation control and other fields. The product has functions such as temperature and current detection, alarm protection and so on.

Technical Specifications

SPA-0P8-2P5-300			
Frequency Range	0.8GHz - 2.5GHz	Input Power	5dBm (max.)
Output Power	300W (min.)	Harmonic	-10dBc (typ.)
P3dB Output Power	50W (min.)	Background Noise	-35dBm/MHz (max.)
Gain	55dB (min.)	Spurious	-60dBc (max.)
Gain Flatness	± 3dB (max.)	Input VSWR	1.5:1 (typ.)
Adjustable Gain	20dB (max.)	Impedance	50 ohm

SPA-0P8-2P5-200 Solid State Power Amplifier

(0.8GHz - 2.5GHz, 200W)

Input Port	N-50KFD, front panel	Output Port	N-50KFD, front panel
Communication Interface	RS485, LAN	Power Supply	AC 220V±10%,
Dimension	19", 4U	Cooling Type	Air cooling
Operating Temperature	0 - 50℃		

Outline Structure

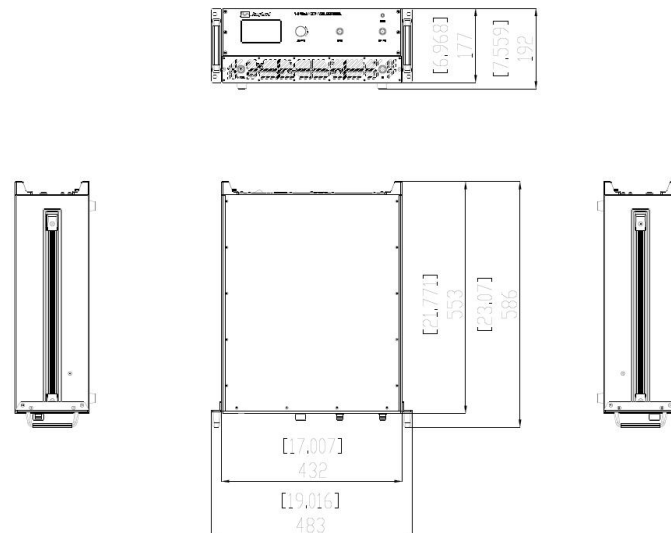

Options

001	Positive/reverse power monitoring
002	Input power detection
003	GPIB interface

Note: Information will conduct the necessary updates, the contents of this document are subject to change without notice.